

2D OVERALL

02 Corporate Office Furniture/ Grade 2 / Thin Base

- [6] 6'x7'6"x95"H POWERED MODULAR WALL STATIONS W/ SLIDING DOORS
- [1] BOX/BOX/FILE PEDESTAL / EA
- [1] FILE/FILE PEDESTAL / EA

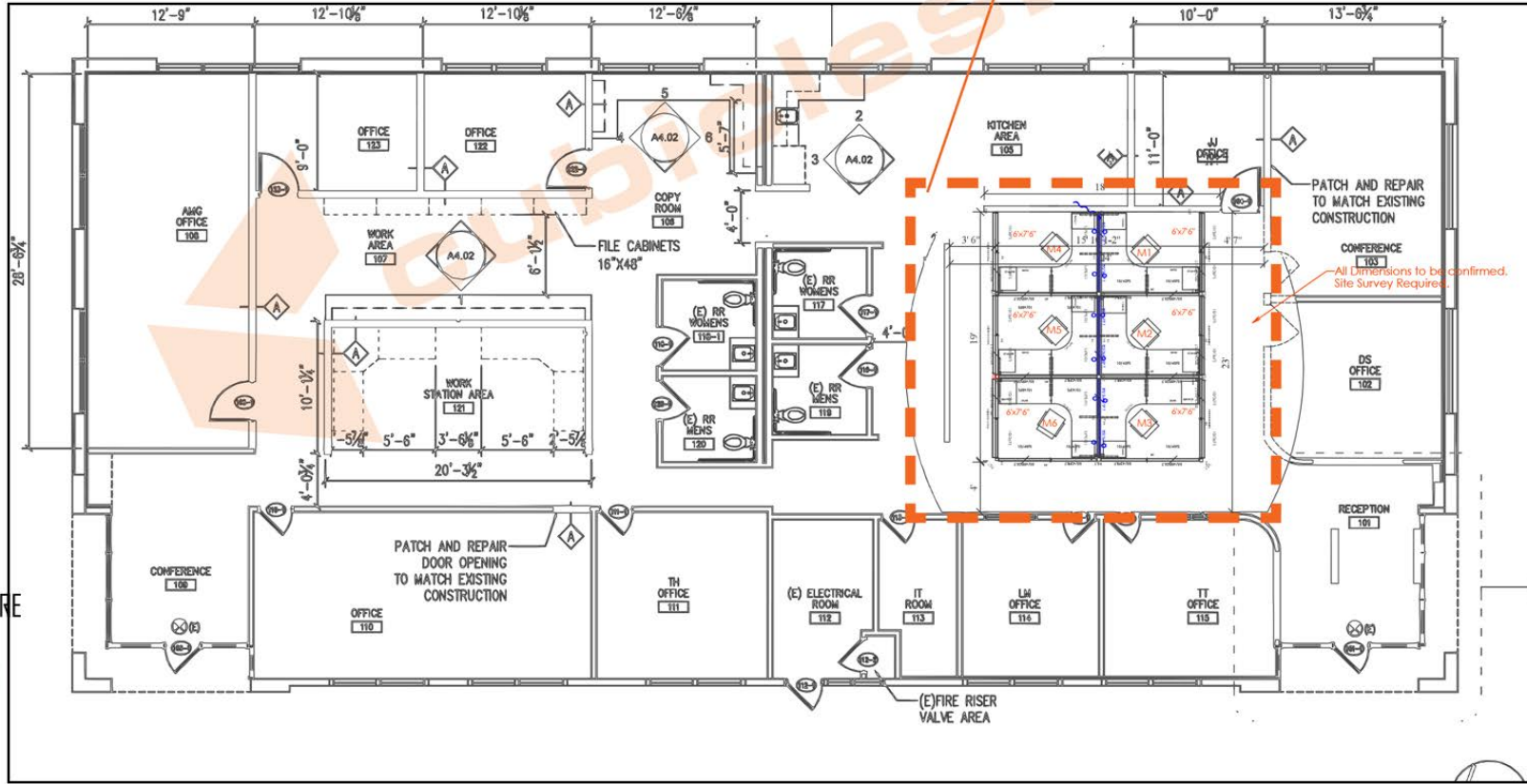
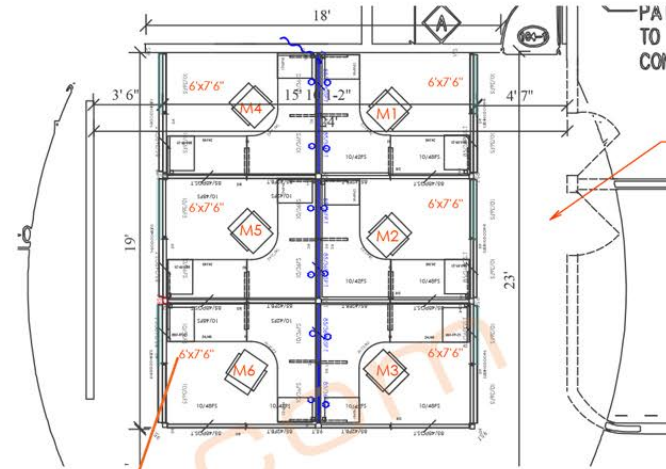

LEGEND:
 BLACK: FURNITURE
 BLUE: POWER
 ORANGE: NOTES